

NOTE
HIGH PRESSURE GAS MAIN IN VICINITY. CONTRACTOR SHALL ALLOW FOR ALL WORKS ASSOCIATED IN PROTECTING THE HIGH PRESSURE MAIN INCLUDING ALL SUPERVISION ALLOWANCES. CONTRACTOR SHALL LIAISE DIRECT WITH WESTNET ENERGY PRIOR TO COMMENCING ANY WORKS.

LEGEND

- EXISTING KERB TO REMAIN
- EXISTING KERB TO BE REMOVED
- PROPOSED KERB
- PROPOSED PATH
- EXISTING HP GAS LINE
- EXISTING MP GAS LINE
- EXISTING SEWER PIPE
- EXISTING TELSTRA CABLE
- EXISTING WATER MAIN
- EXISTING DRAINAGE LINE
- EXISTING TRANSMISSION OVERHEAD POWER LINES
- EXISTING VOCUS COMMUNICATIONS
- EXISTING LOW VOLTAGE UNDERGROUND
- EXISTING HIGH VOLTAGE UNDERGROUND
- EXISTING WESTERN POWER DATA COMMS
- PROPOSED DRAINAGE
- AREA OF EXISTING ROAD TO BE RESHAPED
- AREA OF EXISTING ROAD TO BE REMOVED
- AREA OF EXISTING PATH TO BE REMOVED
- AREA OF EXISTING PATH
- AREA OF GRASS TO BE REINSTATED
- AREA OF NEW PAVEMENT
- EXISTING NORFOLK PINES
- EXISTING TREES

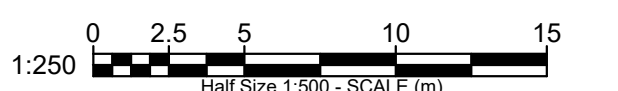
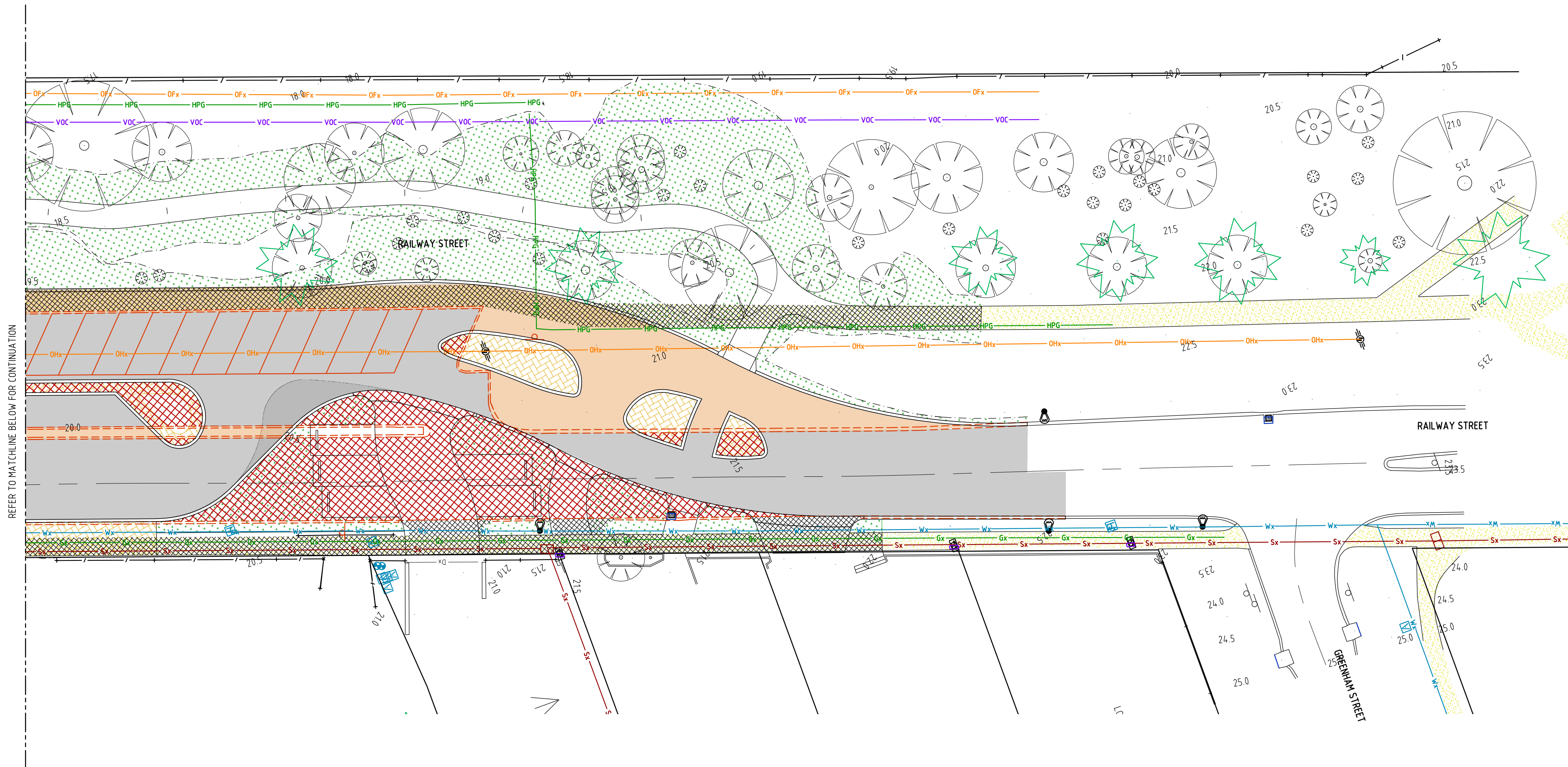

PROJECT:

RAILWAY ST REALIGNMENT NORTH COTTESLOE P.S.

B 29-7-2020
A 14-7-2020
DATE

ADDITIONAL SECTION OF PATH ADDED TO DETAIL DESIGN
PRELIMINARY PLOT FOR APPROVAL
REVISION

MJV
MJV
BY

COPYRIGHT
COPYRIGHT IN THIS DRAWING IS THE PROPERTY OF THE CONSULTANT. THE CLIENT HAS LICENSE TO USE THIS DRAWING FOR THE PROJECT ONLY. THE USER SHALL BE RESPONSIBLE FOR "SITE CHECKING" ALL DIMENSIONS BEFORE COMMENCEMENT OF WORK. LAB DRAWING DO NOT MANUALLY ALTER.
ONLY PLANS WITH NUMERICAL REVISION (REV '1' OR HIGHER) AND SIGNED AS APPROVED SHALL BE USED FOR CONSTRUCTION.

Porter
Consulting Engineers

Level 2 Kishore Court
58 Kishore Road
M5 Pleasant 6153 WA
PO Box 1036
Canning Bridge 6153 WA
Tel (08) 9315 9955
Fax (08) 9315 9959
Email office@portereng.com.au
www.portereng.com.au

CLIENT:

TOWN OF COTTESLOE

DRAWING:

PAVEMENT PLAN

STATUS: **FOR APPROVAL**

SCALE: 1:250
DATE: JULY 2020
DESIGN: ELW
DRAWN: MJV
CHECK:

DRAWING No.

20-4-53/401

REV No.

B A1



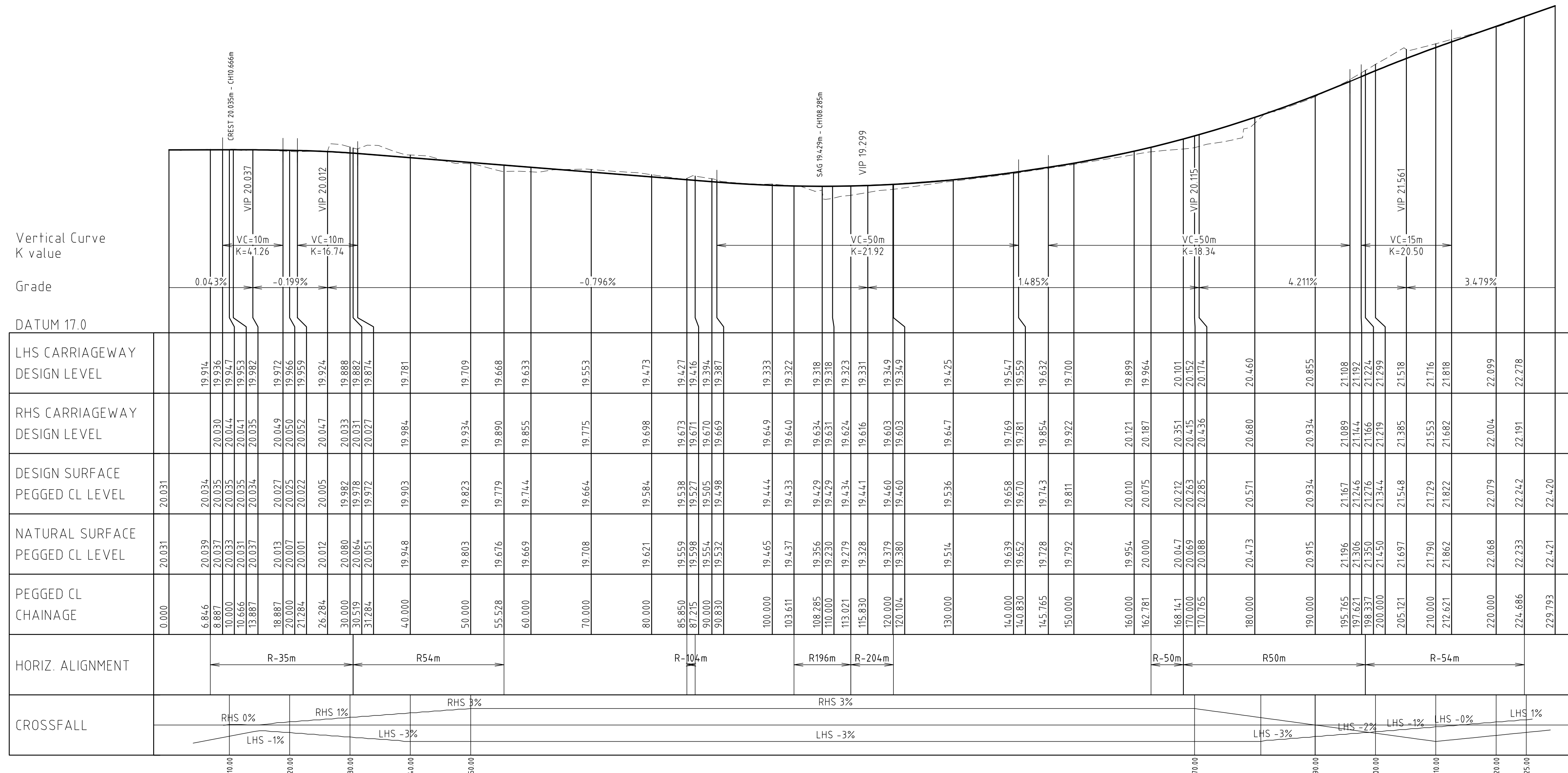
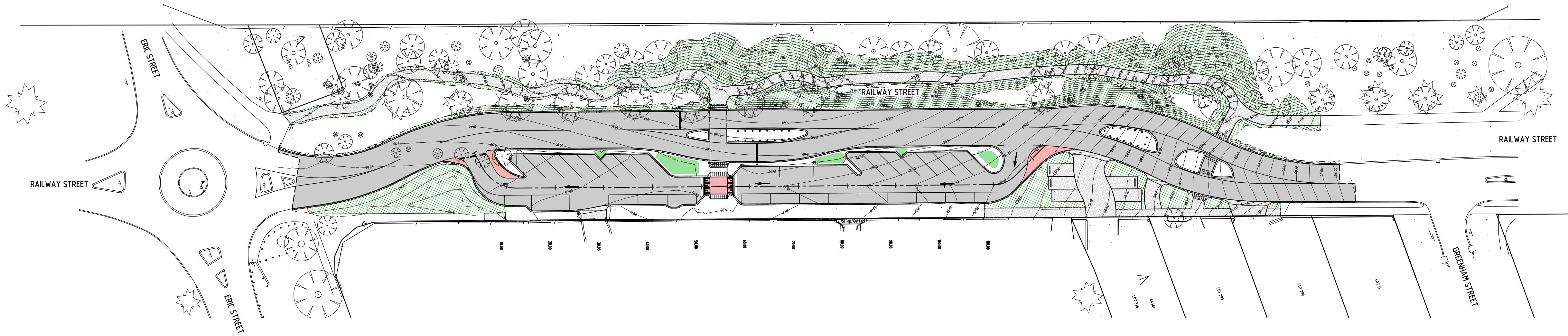

RAILWAY STREET LONGITUDINAL SECTION
HORIZONTAL SCALE 1:500
VERTICAL SCALE 1:50

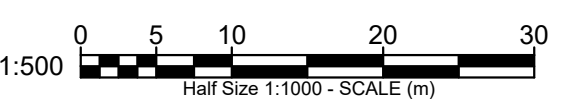
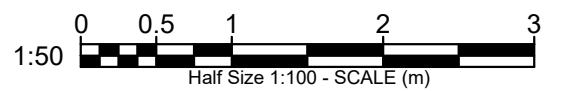

PROJECT:

RAILWAY ST REALIGNMENT NORTH COTTESLOE P.S.

B 29-7-2020
A 19-7-2020
DATE

ADDITIONAL PATH ADDED TO DETAIL DESIGN
PRELIMINARY PLOT FOR APPROVAL
REVISION

MJV
MJV
BY

COPYRIGHT

COPYRIGHT IN THIS DRAWING IS THE PROPERTY OF THE CONSULTANT.
THE CLIENT HAS LICENSE TO USE THIS DRAWING FOR THE PROJECT
ONLY. THE USER SHALL BE RESPONSIBLE FOR "SITE CHECKING" ALL
DIMENSIONS BEFORE COMMENCEMENT OF WORK. LAD DRAWING DO NOT
MANUALLY ALTER

ONLY PLANS WITH NUMERICAL REVISION (REV '1' OR HIGHER) AND
SIGNED AS APPROVED SHALL BE USED FOR CONSTRUCTION

Porter
Consulting Engineers

15000 Pty Ltd ACN 970 971 748 as trustee for The Consulting Engineering Unit Trust trading as Porter Consulting Engineers ABN 78 438 296 395

Level 2 Kishore Court
58 Kishore Road
Mt Pleasant 6153 WA
PO Box 1036
Canning Bridge 6153 WA
Tel (08) 9315 9955
Fax (08) 9315 9959
Email office@portereng.com.au
www.portereng.com.au

CLIENT:

TOWN OF COTTESLOE

DRAWING:

RAILWAY ST REALIGNMENT LONGITUDINAL SECTION

STATUS: **FOR APPROVAL**

SCALE: AS SHOWN

DATE: JULY 2020

DESIGN: ELW

DRAWN: MJV

CHECK:

DRAWING No.

20-4-53/410

FILE NAME S:\ACTIVE PROJECTS\20-04-053\ACAD\20-4-53-410-411.dwg

REV No.

B A1

ORIGINAL
DRAWING
SIZE

1:500

